

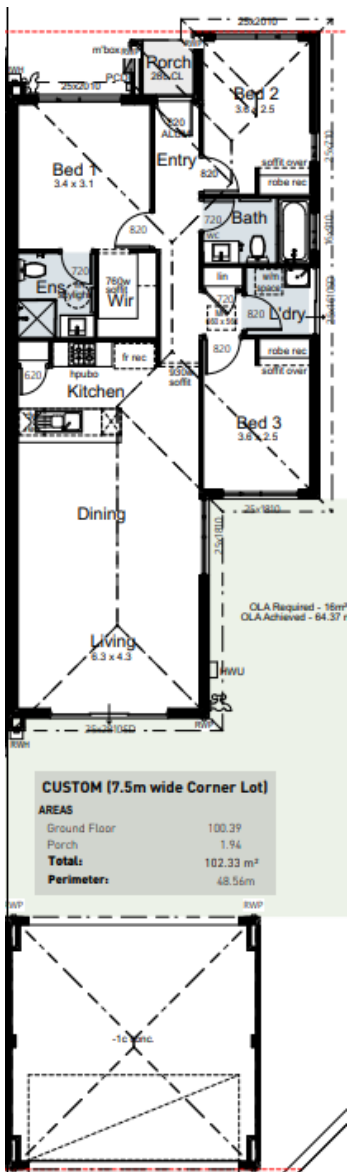

Artist Impression

House & land package
\$560,299



Custom Hvar



3



2



2



Yanchep Junction | Yanchep

Lot 257 Bigola Lane



Lot Size: 265sqm



Awesome features

- Stainless steel appliances
- Caesarstone® benchtops to kitchen & bathrooms
- Primary bedroom with ensuite and walk-in robe
- Robe recess to bed 2 & 3
- Smart Home Pack
- Jason Windows sliding doors and windows
- Double carport with remote sectional door
- 25 year structural guarantee

wa.homebuyers.com.au 131 751



*Full Retail Price \$560,299. Terms and conditions apply. © The Copyright of this design is the sole property of Homebuyers Centre and there is no implied licence for its use for any purpose. Homebuyers Centre is not the owner of the land. Homebuyers Centre has permission from the owner of the land to advertise the land for the price specified. The land price does not include transfer duty, settlement costs and any other fees or disbursements associated with the settlement of the land. Block and building dimensions may vary from the illustration. Prices specified may vary and be subject to change once all site works plans are completed and the current market value of the land and other relevant costs are taken into consideration and Homebuyers Centre and the owner of the land reserve the right to alter the home, land and site work prices. The information and pricing is correct at time of publication. The elevation and imagery are for illustrative purposes only and the elevation is not included in the price of the building (unless specified). This illustrations will depict features not included as standard features for this building or not supplied by Homebuyers Centre including but not limited to elevation features, landscaping features such as planter boxes, turf, letterbox, outdoor areas, retaining walls, water features, pergolas, screens, gates, fences, paving, decking, feature lighting, BBQ's and outdoor kitchens. At the time of printing (4/04/2024) the price was correct and the land was still available for sale. BC5409.



Artist Impression

House & land package
\$499,990*

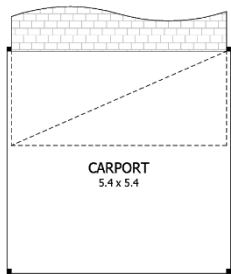

COURTYARD

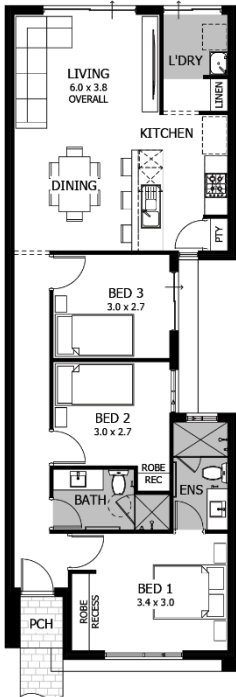

Hvar



3



2



2



Yanchep Junction | Yanchep

Lot 259 Bigola Lane



Lot Size: 180sqm



Awesome features

- Stainless steel appliances
- Caesarstone® benchtops to kitchen & bathrooms
- Primary bedroom with ensuite and walk-in robe
- Robe recess to bed 1 & 2
- Smart Home Pack
- Jason Windows sliding doors and windows
- Double carport with remote sectional door
- 25 year structural guarantee

wa.homebuyers.com.au

131 751

**Homebuyers
Centre**

*Full Retail Price \$499,990. Terms and conditions apply. © The Copyright of this design is the sole property of Homebuyers Centre and there is no implied licence for its use for any purpose. Homebuyers Centre is not the owner of the land. Homebuyers Centre has permission from the owner of the land to advertise the land for the price specified. The land price does not include transfer duty, settlement costs and any other fees or disbursements associated with the settlement of the land. Block and building dimensions may vary from the illustration. Prices specified may vary and be subject to change once all site works plans are completed and the current market value of the land and other relevant costs are taken into consideration and Homebuyers Centre and the owner of the land reserve the right to alter the home, land and site work prices. The information and pricing is correct at time of publication. The elevation and imagery are for illustrative purposes only and the elevation is not included in the price of the building (unless specified). This illustrations will depict features not included as standard features for this building or not supplied by Homebuyers Centre including but not limited to elevation features, landscaping features such as planter boxes, turf, letterbox, outdoor areas, retaining walls, water features, pergolas, screens, gates, fences, paving, decking, feature lighting, BBQ's and outdoor kitchens. At the time of printing (4/04/2024) the price was correct and the land was still available for sale. BC5409.



Artist Impression

House & land package
\$499,990*

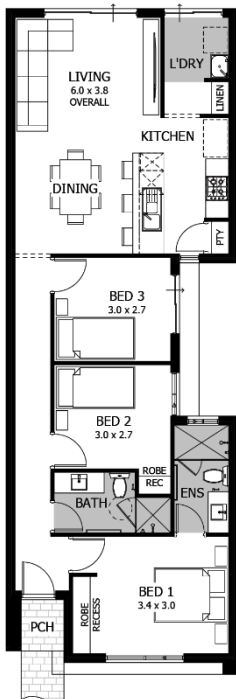
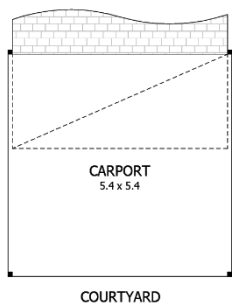

Hvar



3



2



2



Yanchep Junction | YANCHEP

Lot 260 Bigola Lane



Lot Size: 180sqm



Awesome features

- Stainless steel appliances
- Caesarstone® benchtops to kitchen & bathrooms
- Primary bedroom with ensuite and walk-in robe
- Robe recess to bed 1 & 2
- Smart Home Pack
- Jason Windows sliding doors and windows
- Double carport with remote sectional door
- 25 year structural guarantee

wa.homebuyers.com.au 131 751



*Full Retail Price \$499,990. Terms and conditions apply. © The Copyright of this design is the sole property of Homebuyers Centre and there is no implied licence for its use for any purpose. Homebuyers Centre is not the owner of the land. Homebuyers Centre has permission from the owner of the land to advertise the land for the price specified. The land price does not include transfer duty, settlement costs and any other fees or disbursements associated with the settlement of the land. Block and building dimensions may vary from the illustration. Prices specified may vary and be subject to change once all site works plans are completed and the current market value of the land and other relevant costs are taken into consideration and Homebuyers Centre and the owner of the land reserve the right to alter the home, land and site work prices. The information and pricing is correct at time of publication. The elevation and imagery are for illustrative purposes only and the elevation is not included in the price of the building (unless specified). This illustrations will depict features not included as standard features for this building or not supplied by Homebuyers Centre including but not limited to elevation features, landscaping features such as planter boxes, turf, letterbox, outdoor areas, retaining walls, water features, pergolas, screens, gates, fences, paving, decking, feature lighting, BBQ's and outdoor kitchens. At the time of printing (4/04/2024) the price was correct and the land was still available for sale. BC5409.



Artist Impression

House & land package
\$499,990*

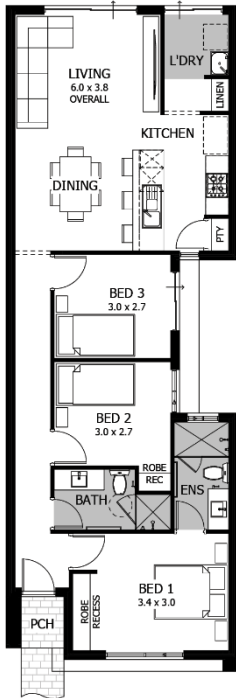
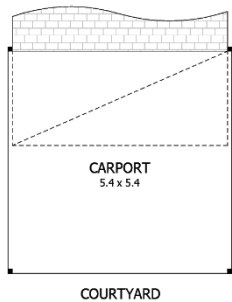

Hvar



3



2



2



Yanchep Junction | YANCHEP

Lot 261 Bigola Lane



Lot Size: 180sqm



Awesome features

- Stainless steel appliances
- Caesarstone® benchtops to kitchen & bathrooms
- Primary bedroom with ensuite and walk-in robe
- Robe recess to bed 1 & 2
- Smart Home Pack
- Jason Windows sliding doors and windows
- Double carport with remote sectional door
- 25 year structural guarantee

wa.homebuyers.com.au 131 751



*Full Retail Price \$499,990. Terms and conditions apply. © The Copyright of this design is the sole property of Homebuyers Centre and there is no implied licence for its use for any purpose. Homebuyers Centre is not the owner of the land. Homebuyers Centre has permission from the owner of the land to advertise the land for the price specified. The land price does not include transfer duty, settlement costs and any other fees or disbursements associated with the settlement of the land. Block and building dimensions may vary from the illustration. Prices specified may vary and be subject to change once all site works plans are completed and the current market value of the land and other relevant costs are taken into consideration and Homebuyers Centre and the owner of the land reserve the right to alter the home, land and site work prices. The information and pricing is correct at time of publication. The elevation and imagery are for illustrative purposes only and the elevation is not included in the price of the building (unless specified). This illustrations will depict features not included as standard features for this building or not supplied by Homebuyers Centre including but not limited to elevation features, landscaping features such as planter boxes, turf, letterbox, outdoor areas, retaining walls, water features, pergolas, screens, gates, fences, paving, decking, feature lighting, BBQ's and outdoor kitchens. At the time of printing (4/04/2024) the price was correct and the land was still available for sale. BC5409.



Artist Impression

House & land package
\$501,990*

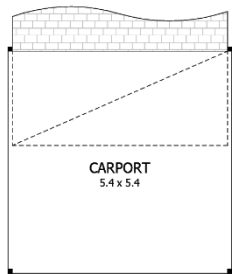

COURTYARD

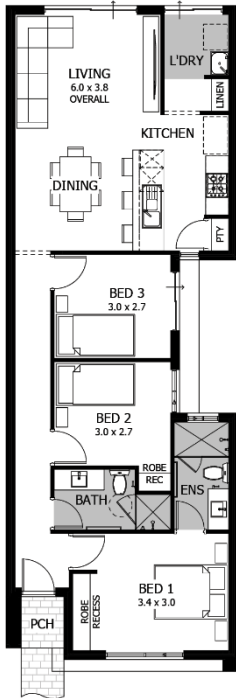

Hvar



3



2



2



Yanchep Junction | YANCHEP

Lot 262 Bigola Lane



Lot Size: 180sqm



Awesome features

- Stainless steel appliances
- Caesarstone® benchtops to kitchen & bathroom
- Primary bedroom with ensuite and walk-in robe
- Robe recess to bed 1 & 2
- Smart Home Pack
- Jason Windows sliding doors and windows
- Double carport with remote sectional door
- 25 year structural guarantee

wa.homebuyers.com.au

131 751

**Homebuyers
Centre**

*Full Retail Price \$501,990. Terms and conditions apply. © The Copyright of this design is the sole property of Homebuyers Centre and there is no implied licence for its use for any purpose. Homebuyers Centre is not the owner of the land. Homebuyers Centre has permission from the owner of the land to advertise the land for the price specified. The land price does not include transfer duty, settlement costs and any other fees or disbursements associated with the settlement of the land. Block and building dimensions may vary from the illustration. Prices specified may vary and be subject to change once all site works plans are completed and the current market value of the land and other relevant costs are taken into consideration and Homebuyers Centre and the owner of the land reserve the right to alter the home, land and site work prices. The information and pricing is correct at time of publication. The elevation and imagery are for illustrative purposes only and the elevation is not included in the price of the building (unless specified). This illustrations will depict features not included as standard features for this building or not supplied by Homebuyers Centre including but not limited to elevation features, landscaping features such as planter boxes, turf, letterbox, outdoor areas, retaining walls, water features, pergolas, screens, gates, fences, paving, decking, feature lighting, BBQ's and outdoor kitchens. At the time of printing (4/04/2024) the price was correct and the land was still available for sale. BC5409.



Artist Impression

House & land package
\$501,990*

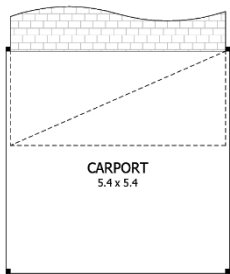

COURTYARD

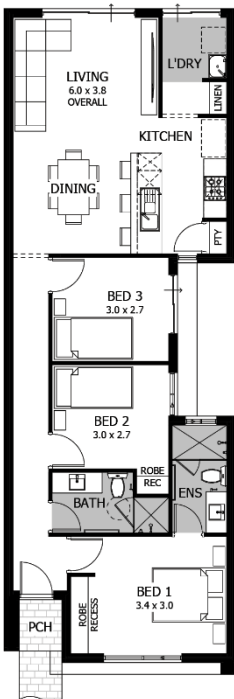

Hvar



3



2



2



Yanchep Junction | YANCHEP

Lot 263 Bigola Lane



Lot Size: 180sqm



Awesome features

- Stainless steel appliances
- Caesarstone® benchtops to kitchen & bathrooms
- Primary bedroom with ensuite and walk-in robe
- Robe recess to bed 1 & 2
- Smart Home Pack
- Jason Windows sliding doors and windows
- Double carport with remote sectional door
- 25 year structural guarantee

wa.homebuyers.com.au 131 751



*Full Retail Price \$501,990. Terms and conditions apply. © The Copyright of this design is the sole property of Homebuyers Centre and there is no implied licence for its use for any purpose. Homebuyers Centre is not the owner of the land. Homebuyers Centre has permission from the owner of the land to advertise the land for the price specified. The land price does not include transfer duty, settlement costs and any other fees or disbursements associated with the settlement of the land. Block and building dimensions may vary from the illustration. Prices specified may vary and be subject to change once all site works plans are completed and the current market value of the land and other relevant costs are taken into consideration and Homebuyers Centre and the owner of the land reserve the right to alter the home, land and site work prices. The information and pricing is correct at time of publication. The elevation and imagery are for illustrative purposes only and the elevation is not included in the price of the building (unless specified). This illustrations will depict features not included as standard features for this building or not supplied by Homebuyers Centre including but not limited to elevation features, landscaping features such as planter boxes, turf, letterbox, outdoor areas, retaining walls, water features, pergolas, screens, gates, fences, paving, decking, feature lighting, BBQ's and outdoor kitchens. At the time of printing (4/04/2024) the price was correct and the land was still available for sale. BC5409.



Artist Impression

House & land package
\$501,990*

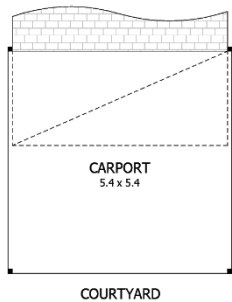

COURTYARD

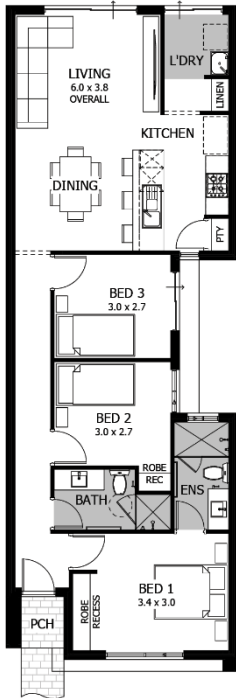

Hvar



3



2



2



Yanchep Junction | YANCHEP

Lot 264 Bigola Lane



Lot Size: 180sqm



Awesome features

- Stainless steel appliances
- Caesarstone® benchtops to kitchen & bathrooms
- Primary bedroom with ensuite
- Robe recess to bed 1 & 2
- Smart Home Pack
- Jason Windows sliding doors and windows
- Double carport with remote sectional door
- 25 year structural guarantee

wa.homebuyers.com.au

131 751



**Homebuyers
Centre**

*Full Retail Price \$501,990. Terms and conditions apply. © The Copyright of this design is the sole property of Homebuyers Centre and there is no implied licence for its use for any purpose. Homebuyers Centre is not the owner of the land. Homebuyers Centre has permission from the owner of the land to advertise the land for the price specified. The land price does not include transfer duty, settlement costs and any other fees or disbursements associated with the settlement of the land. Block and building dimensions may vary from the illustration. Prices specified may vary and be subject to change once all site works plans are completed and the current market value of the land and other relevant costs are taken into consideration and Homebuyers Centre and the owner of the land reserve the right to alter the home, land and site work prices. The information and pricing is correct at time of publication. The elevation and imagery are for illustrative purposes only and the elevation is not included in the price of the building (unless specified). This illustrations will depict features not included as standard features for this building or not supplied by Homebuyers Centre including but not limited to elevation features, landscaping features such as planter boxes, turf, letterbox, outdoor areas, retaining walls, water features, pergolas, screens, gates, fences, paving, decking, feature lighting, BBQ's and outdoor kitchens. At the time of printing (4/04/2024) the price was correct and the land was still available for sale. BC5409.



Artist Impression

House & land package
\$501,990*

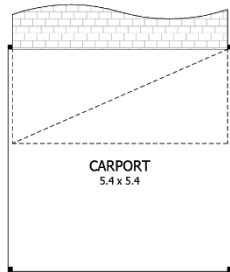

COURTYARD

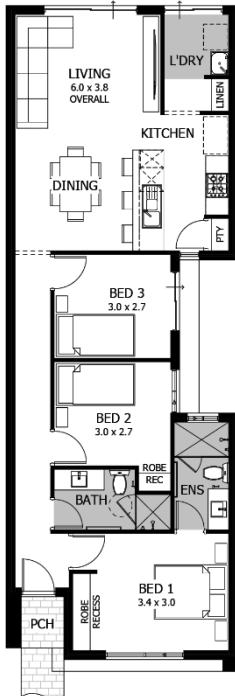

Hvar



3



2



2



Yanchep Junction | YANCHEP

Lot 265 Bigola Lane



Lot Size: 180sqm



Awesome features

- Stainless steel appliances
- Caesarstone® benchtops to kitchen & bathrooms
- Primary bedroom with ensuite
- Robe recess to bed 1 & 2
- Smart Home Pack
- Jason Windows sliding doors and windows
- Double carport with remote sectional door
- 25 year structural guarantee

wa.homebuyers.com.au

131 751



**Homebuyers
Centre**

*Full Retail Price \$501,990. Terms and conditions apply. © The Copyright of this design is the sole property of Homebuyers Centre and there is no implied licence for its use for any purpose. Homebuyers Centre is not the owner of the land. Homebuyers Centre has permission from the owner of the land to advertise the land for the price specified. The land price does not include transfer duty, settlement costs and any other fees or disbursements associated with the settlement of the land. Block and building dimensions may vary from the illustration. Prices specified may vary and be subject to change once all site works plans are completed and the current market value of the land and other relevant costs are taken into consideration and Homebuyers Centre and the owner of the land reserve the right to alter the home, land and site work prices. The information and pricing is correct at time of publication. The elevation and imagery are for illustrative purposes only and the elevation is not included in the price of the building (unless specified). This illustrations will depict features not included as standard features for this building or not supplied by Homebuyers Centre including but not limited to elevation features, landscaping features such as planter boxes, turf, letterbox, outdoor areas, retaining walls, water features, pergolas, screens, gates, fences, paving, decking, feature lighting, BBQ's and outdoor kitchens. At the time of printing (19/03/2024) the price was correct and the land was still available for sale. BC5409.